

DEMOLITION GRAB

AG12060

DMS
DMS Technologie GmbH

TECHNICAL DATA

Excavator size-class	[t]	8-12
Weight (without rotator)	[kg]	640
Rotator weight	[kg]	88
Operating pressure gripping max.	[bar]	320
Operating pressure rotation max.	[bar]	320
Closing force	[kN]	46
Torque	[Nm]	4200
Capacity	[l]	264
Rec. litre capacity rotation	[l]	15-30
Rec. litre capacity gripping	[l]	40-150

TECHNICAL ILLUSTRATION

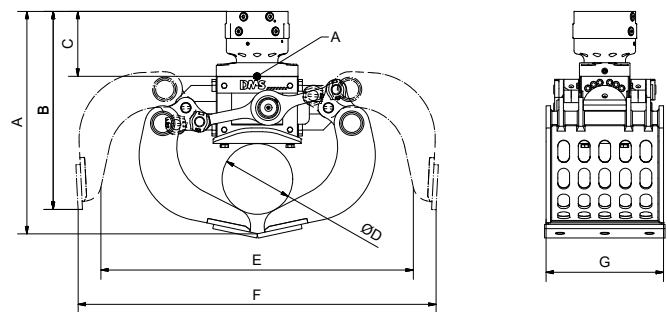

Dimension A	[mm]	1149	Dimension E	[mm]	1551
Dimension B	[mm]	1032	Dimension F	[mm]	1855
Dimension C	[mm]	239	Dimension G	[mm]	600
Dimension D	[mm]	Ø 410			

AVAILABLE ACCESSORIES

- / Softgrip in combination with tooth conversion kit
- / Pipegrip in combination with tooth conversion kit
- / Tooth Conversion Kit
- / Adapter for other quick coupling systems upon request
- / Adapter flange for custom solution
- / Bolt-on adapter for quick coupling system Lehnhoff MS/HS

SCOPE OF DELIVERY

- / Grab including shells
- / Bolt-on cutting edges
- / Rotator

You can find more information and a 3D preview at www.dms-tec.de

