

DEMOLITION GRAB

AG18090

DMS
DMS Technologie GmbH

TECHNICAL DATA

Excavator size-class	[t]	11-18
Weight (without rotator)	[kg]	873
Rotator weight	[kg]	164
Operating pressure gripping max.	[bar]	320
Operating pressure rotation max.	[bar]	320
Closing force	[kN]	52
Torque	[Nm]	4200
Capacity	[l]	562
Rec. litre capacity rotation	[l]	15-30
Rec. litre capacity gripping	[l]	40-150

TECHNICAL ILLUSTRATION

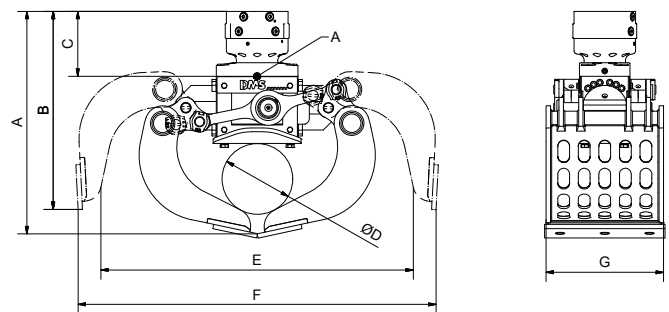

Dimension A	[mm]	1286	Dimension E	[mm]	1629
Dimension B	[mm]	1283	Dimension F	[mm]	1945
Dimension C	[mm]	277	Dimension G	[mm]	900
Dimension D	[mm]	Ø 507			

AVAILABLE ACCESSORIES

- / Softgrip in combination with tooth conversion kit
- / Pipegrip in combination with tooth conversion kit
- / Tooth Conversion Kit
- / Adapter for other quick coupling systems upon request
- / Adapter flange for custom solution
- / Bolt-on adapter for quick coupling system Lehnhoff MS/HS

SCOPE OF DELIVERY

- / Grab including shells
- / Bolt-on cutting edges
- / Rotator

You can find more information and a 3D preview at www.dms-tec.de

